



Glion Dolly Electric Scooter User Manual



Glion Dolly Electric Scooter User Manual

Thank you for purchasing a Glion Electric Scooter. For your safety and the reliable operation of this product, please carefully read this User Manual in its entirety AND VIEW INSTRUCTIONAL VIDEOS on our website BEFORE operating this product. The information in this manual is accurate as of the time of printing. To determine whether updates have been added, please visit our website at www.glion-scooter.com for the latest version of the User Manual. The website also provides videos demonstrating how to fold, unfold, and operate the scooter. Your Glion Electric Scooter is covered by a warranty. For the specifics of this warranty, visit our website at www.glion-scooter.com. Please register your Glion Electric Scooter at www.glion-scooter.com for warranty coverage.

Please do not hesitate to contact us if you have any questions:

support@glion-scooter.com

www.glion-scooter.com

Probit Cell LLC

701 4th Avenue, Suite 7

Holdrege, NE 68949



WARNING: THIS MANUAL CONTAINS IMPORTANT SAFETY, PERFORMANCE, AND SERVICE INFORMATION. Read it before you take the first ride on your new Glion Electric Scooter, and keep it for reference.

Whenever you ride this motorized scooter, you risk death or serious injury from loss of control, collisions, and falls. **THIS IS NOT A STUNT VEHICLE, AND SHOULD NOT BE USED AS SUCH.** When riding, use common sense and good judgment: Always wear a helmet. Ride on legal surfaces. Ride at a speed you can control. Be alert and prepared for changes in your riding surface. Never ride intoxicated or in any other manner that impairs your ability to drive this scooter safely. Yield to pedestrians at ALL TIMES!



TABLE OF CONTENTS

SAFETY SPECIFICATIONS AND OWNER OBLIGATIONS	3
GLĪON MODEL 225 SPECIFICATIONS	6
GLĪON Model 225 PARTS DIAGRAM	7
UNFOLD/FOLD INSTRUCTIONS.....	8
OVERVIEW OF YOUR GLĪON ELECTRIC SCOOTER	11
OPERATING YOUR GLĪON ELECTRIC SCOOTER	13
BATTERY AND CHARGER	15
DOLLY FEATURE	17
SCOOTER COVER (OPTIONAL ACCESSORY).....	18
GLĪON ELECTRIC SCOOTER MAINTENANCE	19
GENERAL TROUBLESHOOTING	20
CLEANING, STORING, AND SERVICING	21
PRODUCT REGISTRATION.....	21
GLĪON LIMITED WARRANTY	22

SAFETY SPECIFICATIONS AND OWNER OBLIGATIONS

1. **LEGAL RIDING LOCATIONS:** Always check and obey local laws or regulations, which govern where you can legally operate the scooter. Only operate the scooter where legally permitted, and do so with caution. The scooter can only be operated on private property unless it is street legal in your jurisdiction. While many state laws approve its legal use in bike lanes, some states do not consider a motorized scooter street legal. Please familiarize yourself with the applicable laws and regulations for electric scooters where you plan on riding it. Keep safely away from cars and motor vehicle traffic at all times.



WARNING: Many states require specific safety devices. It is your responsibility to familiarize yourself with the laws of the state where you ride and to comply with all applicable laws, including properly equipping yourself and your electric scooter as the law requires. Observe all local electric scooter laws and regulations. Observe regulations about electric scooter lighting, licensing of electric scooters, riding on sidewalks, laws regulating bike path and trail use, helmet laws, and special electric scooter traffic laws. **IT'S YOUR RESPONSIBILITY TO KNOW AND OBEY THE LAWS.**

2. **SAFETY GEAR:** Always wear an approved safety helmet (with chin strap securely buckled), gloves, elbow and knee pads, appropriate shoes (lace-up with rubber soles), and bright or reflective clothing while operating this scooter.



WARNING: Failure to wear a helmet while riding may result in serious injury or death.

3. **SAFE OPERATING CONDITIONS:**

- Do not operate this scooter in traffic.
- Do not operate this scooter on surfaces that are wet, frozen, oily, or unpaved.
- Never carry passengers or objects that can hinder your ability to safely operate this scooter.
- Never use headphones or a cell phone to talk or text while riding.

4. **PREGNANT OPERATORS:** Pregnant women should not operate this scooter.

5. **DRIVING IMPAIRED:** Never use alcohol or drugs before or while operating this scooter. The use of such hinders your ability to safely operate the scooter.

6. **STUNTS:** This scooter is not designed for stunts or tricks and should not be used as such. High speeds, jumps, wheelies, and other trick maneuvers are dangerous and can result in loss of control, accidents, and injury/death to self or others.

7. **HILLS:** When climbing hills, you may need to manually kick the scooter forward to assist the motor and maintain your speed depending on the steepness of the hill and rider weight. **WHEN DESCENDING HILLS, CAREFULLY CONTROL YOUR SPEED! The scooter has a short wheel base. It may become unsteady at excessive speeds. Avoid excessive speeds that can be associated with downhill rides.** The brake is an electronic brake. The scooter must be turned on for it to work. Always turn the power switch on to enable the brake and check the brake BEFORE beginning to go downhill. Never go downhill without brake being enabled.



WARNING: Failure to control your speed when descending a hill can result in serious injury or death.

8. **GUEST USE:** Never permit a guest to use this scooter unless the guest has read the user manual and all the warnings. Always provide a guest with helmet, elbow pads, and knee pads before permitting the guest to operate the scooter. Never allow more than one person at a time to ride the scooter.



WARNING: This product should not be used by persons unwilling or unable to take responsibility for their own actions.

9. **INSURANCE:** YOUR INSURANCE POLICIES MAY NOT PROVIDE COVERAGE FOR ACCIDENTS INVOLVING THE USE OF THIS SCOOTER. TO DETERMINE IF COVERAGE IS PROVIDED, CONTACT YOUR INSURANCE COMPANY OR AGENT **BEFORE** USING THE SCOOTER.

10. **OPERATOR AGE:** Do not allow anyone under the age of 16 to operate this scooter. This scooter is designed for operation by and the transport of only one person age 16 or older.

11. **SURROUNDINGS:** Ride your scooter in a controlled environment away from vehicles, obstacles, and other hazards. Never operate the scooter near steps or swimming pools.

12. **INTENDED USE:** This scooter is not designed or intended for stunt tricks, including but not limited to jumps, wheelies, and curb grinding. Keep both hands on the handlebar and both feet on the standing board while operating the scooter.

13. **SPEED:** The scooter's maximum speed is approximately 25 km/h (15 mph). For your safety, limit the speed to not more than 20 km/h (13 mph), and be careful to control your speed when descending hills. The scooter has a short wheel base and can become unsteady at excessive downhill speeds.

14. **VISIBILITY:** Do not ride your scooter at night or in conditions of poor visibility. If riding in such conditions is unavoidable, limit your speed to 15 km/h (10 mph) or less, wear a hands-free headlamp flashlight/rearlight and reflective clothing or vest. There are aftermarket bicycle accessories such as headlamps, rear lights, reflectors, and horns that can be mounted to the scooter or worn by the rider that will enhance safety.



WARNING: Riding at dawn, dusk, or at times of poor visibility without a lighting system that meets state and local laws, and without approved reflectors, is illegal, dangerous, and can result in serious injury or death.

15. **TEMPERATURE:** Do not use the scooter when the temperature is below -5 C (23 degrees F).

16. **WEATHER CONDITIONS:** Avoid riding in wet or icy conditions. Stop the scooter and walk it across rough or slippery road conditions.



WARNING: Wet or icy weather impairs traction, braking, and visibility for riders and other vehicles and pedestrians sharing the roads. The risk of accident is dramatically increased in wet or icy conditions.

17. SURFACE CONDITIONS: The scooter is intended for use on hard, flat, dry paved surfaces without loose debris such as sand, leaves, rocks or gravel. Wet, slick, bumps, uneven or rough surfaces may impair traction and contribute to possible accidents. **Do not ride your scooter in mud, gravel, sand, ice, or water. Watch out for potential obstacles that could catch your wheel or force you to swerve suddenly or lose control. Avoid sharp bumps, drainage grates and sudden surface changes.** Stop the scooter and carefully walk it across rough or slippery road conditions.

18. WATER RESISTANCE: Although some water resistance measures have been made, riding the scooter through standing water, rain, wet or muddy conditions runs the risk of severely damaging it. Do not immerse the scooter in water or directly spray the scooter when cleaning. When parked outside where rain is possible, cover the handlebar controls with water resistant materials to protect the electric controls.

19. SAFETY WHEN NOT RIDING: When the scooter is not being used for riding, place it in a safe stable and secured environment, keep it away from fire, water and other hazards. When the scooter is in its upright vertical self-standing mode, especially in moving public transportation or other crowded space, pay attention to its stability as accidental tip over could cause personal injury as well as damage to the scooter. **Always hold the retractable dolly handle to prevent it from tipping over and falling to the ground.**

GLĪON MODEL 225 SPECIFICATIONS

Size	Unfolded Dimension	970x1150x410mm (38"x45"x16")
	Folded Dimension	950x300x200mm (37"x12"x8")
	Net Weight	13 Kg (28 lbs)
Performance	Maximum Load	115 KG (255 lbs)
	Top Speed	25km/h* (15 mph)
	Range	25km* (15 m)
Battery	Voltage	36V
	Type	Li-ion Battery
	Capacity	7.8AH
Motor	Type	Brushless DC Motor
	Rated Output Power	250W
	Rated Voltage	36V
Charger	Input Voltage	100-240V
	Charging time	3.5h

* Top speed and range per charge depends on rider weight, wind speed, temperature, riding style, riding surface, battery condition, and other factors. Actual top speed and range per charge may vary.

GLĪON Model 225 PARTS DIAGRAM



Scooter Side View Unfolded

UNFOLD/FOLD INSTRUCTIONS

For video instructions, please visit our website at www.glion-scooter.com. We encourage you to view the video instructions prior to unfolding/folding operation to avoid damage to your Glion scooter.

UNFOLDING YOUR SCOOTER:

LED Battery Indicator

Power Button

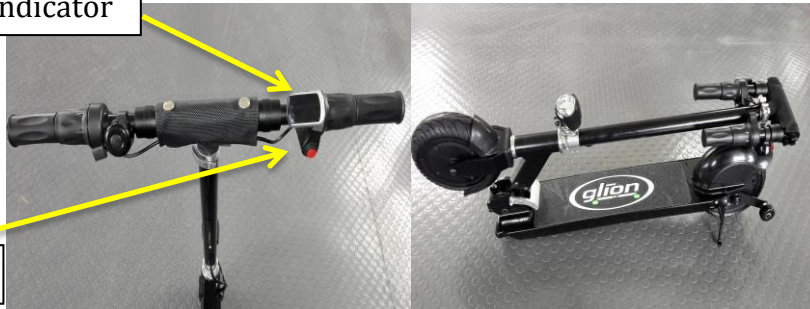

Step 1. Make sure the scooter is turned off. The LED battery indicator lights on the right handle grip should not be lit.

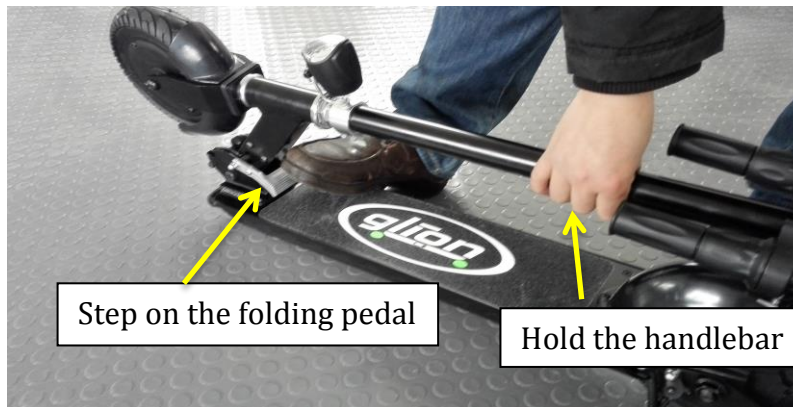

Step 2. Step on the folding pedal and lift the handlebar, **push the handlebar forward until you hear it click and lock into place in the unfolded or operating position. Make sure the folding pin completely sits at the bottom of the notch.**

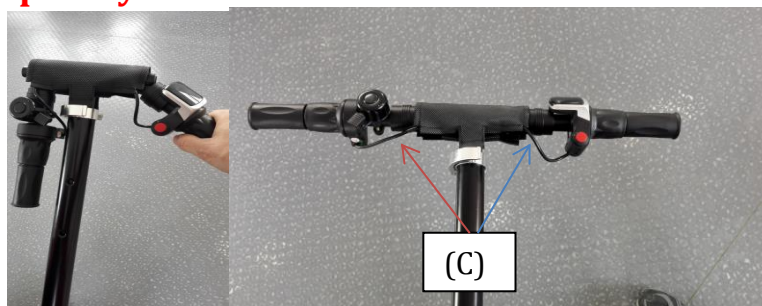

Step 3. Lift the handlebar grips until the left and right t-bar collars (C) snap into place and the handle grips are locked in the operating position.



Step 4. Open the handlebar's quick release lever (D).

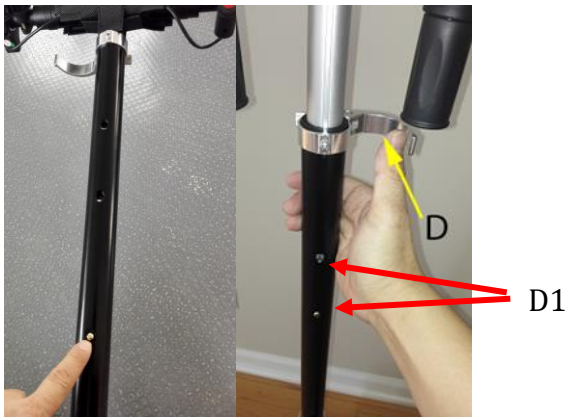

Step 5. Press the handlebar height adjustment button and raise the handlebar to the desired height until you hear it click and lock into place. You have two handlebar heights to choose from (D1). Lift up and push down on the handlebar to ensure it is securely locked into place. Tightly close the quick release lever (D). **Make sure the quick release lever is securely tightened.** You should have to press firmly on the quick release lever to close it. If the quick release lever is loose when closed, open the quick release, thumb tighten the quick release nut and then firmly close it.

FOLDING YOUR SCOOTER:



Step 1. Make sure the scooter is off. The LED battery indicator screen on the right handle grip should not be lit. Open the handlebar quick release lever (D). Press in the handlebar height button (E) and lower handlebar T-bar to the folded position (E1). The handlebar height adjustment button should lock into place in the folded position. Close the quick release lever (D).



Step 2. Fold the handlebar grips by first fully pulling the T-bar collar (C) out and then folding the grip down. Do the same for each side.



Step 3. **While pushing the T-bar a little forward**, put one foot on the folding pedal and press down. The folding mechanism should unlock. (Pushing T-bar forward is very important as it unlocks the folding pedal. Without pushing T-bar forward while stepping on the folding pedal could damage the folding mechanism)



Step 4. Fold down the handlebar until you hear a click and the folding mechanism locks into the folded position.

OVERVIEW OF YOUR GLION ELECTRIC SCOOTER



WARNING: For your safety, please take the time to familiarize yourself with the handlebar controls and with its movements and balance before attempting to ride your scooter with the motor engaged. Please see our demonstration videos on our website www.glion-scooter.com.

1. **Powering On/Off:** To turn the scooter on or off, you must press and hold for about 2 seconds the red on/off switch as shown below (**F**). The LED display is lit when the power is on and dark if off. The scooter will automatically turn off after five minutes of non-use.
2. **Head Light/Rear Light On/Off:** To turn the headlight/rear light on or off, you must first turn power on the scooter. While the scooter power is on, quickly press the on/off switch once, the headlight/rear light should be turned on. Flash press a second time, the lights will be turned off. Again, to turn on or off the scooter, press and hold for about two seconds. Turning the lights on or off is a quick press.

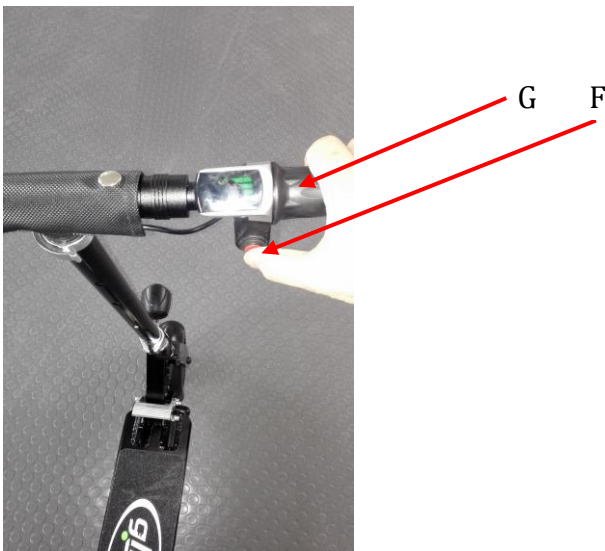

3. **Accelerator:** The right twist grip is the accelerator (**G**). The further you twist the accelerator towards you, the more energy you will release to the motor. **NOTE:** As a safety feature, to prevent unintended motor engagement, the motor will not start from a stand-still position should you accidentally twist the accelerator. You must first manually kick the scooter forward for initial speed before the twist grip accelerator will release energy to the motor. Also, the scooter is rear wheel drive. Be sure to have your body weight towards the front of the scooter when engaging the motor to avoid a wheelie.

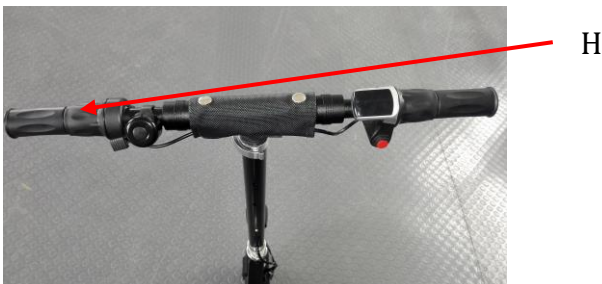

4. **Brake:** The left twist grip is the brake **(H)**. The brake is an electric antilock brake located inside of the rear hub motor. The further you twist the left grip towards you, the more braking force is applied. **The electronic brake only works when the scooter is turned on.** As an additional safety feature, the scooter is designed to cut power to the motor when the brake is applied. In the case where the wiring of the electric brake is damaged, the motor will not start to prevent accidents. **In a safe, controlled environment, please familiarize yourself with the braking distance of the scooter at different speeds before operating near intersections, pedestrians and other obstacles.**



5. **Emergency Foot Press Brake:** The scooter is equipped with a rear foot press brake for emergency usage. In case additional braking is needed, use non-pivoting foot to press on the rear fender to stop the scooter motor. **Please keep in mind, frequent usage of the emergency brake may result in faster depreciation of the motor tire. Wear and tear of the motor tire is NOT included in manufacturer warranty.**



6. **Kickstand:** The kickstand (I) is located towards the rear wheel on the left side of the standing board. Be sure to always lift the kickstand before beginning operation of the scooter.

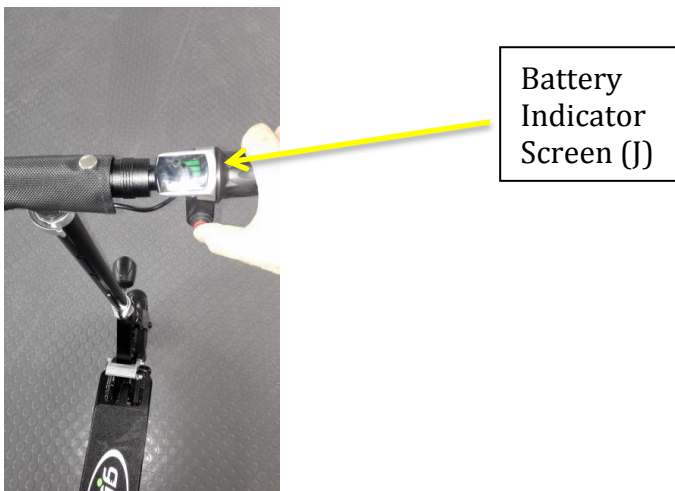

7. **Battery Indicator.** When the scooter is turned on, the battery indicator screen is turned on **(J)**. F means full or close to full while E means empty. **Do not check the battery**

indicator lights when operating the scooter. The battery indicator is only accurate when the motor is not engaged.

8. **Dolly Feature.** The Dolly Feature includes the wheelies located behind the rear wheel and the retractable handle located at the front of the standing board. The dolly handle has three positions (see photos on page 18). Position 1: The closed position. Here, the dolly handle is fully retracted into the board and locked into place so that it cannot be extended without first pressing the center button. Position 2: The dolly handle is partially extended. This position is designed for ease in lifting the folded scooter with the dolly handle (i.e., up a set of stairs). Position 3: The dolly handle is fully extended. This position is for rolling the folded scooter behind or next to you. The wheelies allow the scooter to roll by your side and also to stand vertically with the wheelies and the T-bar as the base. See Model Dolly Features on page 18 for further details.



WARNING: For your safety and for the safety of others, please take the time to practice accelerating, braking and familiarize yourself with the scooter's braking distance in an open and safe area before taking your scooter out into the general environment. IT IS YOUR RESPONSIBILITY TO MAINTAIN CONTROL OF YOUR SCOOTER AT ALL TIMES!

OPERATING YOUR GLĪON ELECTRIC SCOOTER

Getting Ready:

1. Fully charge the battery. For safety reasons, the battery is only 50% charged when shipped from the factory (See Page 16 Battery Charging Instructions Below).
2. Choose a controlled environment away from vehicles, obstacles, and other hazards for riding. **Even if you have experience with motorized scooters, vehicles, bicycles, etc., you must familiarize yourself with the function, handling, braking distance, performance, and safety of this scooter in a safe and controlled environment.**
3. Always check and obey all local laws and regulations. *Your insurance policies may or may not provide coverage for accidents involving the use of this motorized scooter. To determine if coverage is provided, check with your insurance company or agent. Do not assume your existing insurance policies provide coverage.*
4. Unfold the scooter (See Unfolding Instructions above).
5. Adjust the handlebar to your height.
6. Raise the kickstand.
7. Complete a final roadworthiness safety check before operation.
 - a. Make sure folding mechanism, handlebar height adjust button, dolly handle and handlebar quick release, wheel lug nuts, other nuts, bolts, fasteners, etc., are secure.
 - b. Inspect the frame, fork and handlebars for cracks or broken connections.
8. IF RIDING YOUR ELECTRIC SCOOTER FOR THE FIRST TIME, FAMILIARIZE YOURSELF WITH ITS MOVEMENTS AND BALANCING ON IT BY **MANUALLY OPERATING IT WITH THE POWER TURNED OFF.** **NOTE: THE ELECTRONIC TWIST GRIP BRAKE DOES NOT WORK WHEN THE POWER IS TURNED OFF, SO CAREFULLY CONTROL YOUR SPEED!** IN A SAFE AND CONTROLLED ENVIRONMENT, ON A FLAT SURFACE, FACING FORWARD, WITH BOTH HANDS SECURELY ON THE HANDLEBAR GRIPS, PLACE ONE FOOT TOWARDS THE FRONT OF THE STANDING BOARD AND THE OTHER FOOT ON THE GROUND. USE THE GROUND LEG TO MANUALLY PUSH OR KICK THE SCOOTER FORWARD. ONCE YOU GAIN SOME SPEED, GENTLY PLACE THE GROUND FOOT ON

THE STANDING BOARD BEHIND YOUR FRONT FOOT. REPEAT THE SAME MOVEMENTS ONCE THE SCOOTER SLOWS DOWN TO KEEP IT PROPELLED FORWARD. RIDING THE SCOOTER WITHOUT THE POWER ENGAGED DOES NOT DAMAGE IT, BUT REMEMBER THERE ARE NO ELECTRONIC BRAKES IN THIS MODE. **DO NOT OPERATE THE SCOOTER WITH THE POWER TURNED ON UNTIL YOU FEEL CONFIDENT MANUALLY PROPELLING THE SCOOTER.**

Riding the Scooter Powered:

1. Raise the kickstand.
2. Press and hold the red power button on the right twist grip about two seconds to turn on the scooter. The battery indicator screen on the right handle grip should be lit when the scooter is turned on.
3. With both hands on the handlebar and one foot located towards the front half of the standing board and one foot on the ground, manually push the scooter forward and slowly twist the accelerator. **The scooter is rear wheel drive. Be sure to have the foot on the standing board located towards the front of the standing board when engaging the motor to avoid a wheelie.**
4. As the motor begins to slowly propel the scooter forward, place the foot which pushed off the ground onto the riding board behind your front foot. Twist the right grip more to increase speed and carefully Glion. Remember, as a safety feature, you will have to manually propel the scooter to reach a minimum speed before the electric motor will engage. If you manually propel the scooter and the motor does not engage, it might be because you did not reach the minimum speed.

Stopping the Scooter:

1. Twist the left grip toward you to begin the braking process. The harder and faster you twist, the quicker the stopping process. The brake is located in the rear wheel. In a safe, controlled environment, please familiarize yourself with the braking distance of the scooter at various speeds before operating near intersections, pedestrians and other obstacles.



WARNING: Always ride at speeds you can comfortably and safely control. Take the time to familiarize yourself with the electronic brakes and the distance it takes to come to a complete stop at various speeds. Keep both hands on the handle grips while operating the scooter at all times. Failure to do so could result in serious injury or death.

BATTERY AND CHARGER

Each electric scooter is equipped with a lithium battery and a smart charger designed specifically for each other. **ONLY USE THE CHARGER SUPPLIED BY THE MANUFACTURER TO CHARGE THE SCOOTER.** Do not charge the battery with any other charging system. If the battery or charger is damaged due to improper use, the limited manufacturer warranty shall be void. Do not operate the charger near flammable materials such as carpet. Ensure a dry environment. Never allow the charger or cable to come into contact with water as this may result in electric shock. Never touch the charger or cable with wet hands. Disconnect the charger from the outlet if any fault arises during charging. Always pull the plug, not the cable. Do not allow the charger or cables to be damaged or crushed by sharp edges or heat. The charger supplied with the electric scooter should be regularly examined for damage to the cord, plug, enclosure and other parts. In the event of such damage, the scooter must not be charged until the charger has been repaired or replaced. Unplug the charger and disconnect from the scooter when not in use.

BATTERY:

1. Fully charge the battery before first time operation or first time after a long period of non-usage (see *Instructions For Charging* below). For safety reasons, the battery is only 50% charged when shipped from the factory. The battery is fully charged when the LED light on the charger turns green.
2. Always charge the battery in a clean, dry location, free of debris.
3. Charge the battery frequently. The battery can be recharged at any time. Do not think that you need to fully deplete the battery before recharging it. In fact, frequent partial discharge/charge cycles will prolong the battery life vs. full discharge/charge cycles.
4. Fully charge the battery before storing the scooter for extended periods.
5. When not in use, periodically recharge the battery once every three months.
6. Battery damage due to water, collision, improper storage and other non-normal factors is not covered by the limited manufacturer warranty.

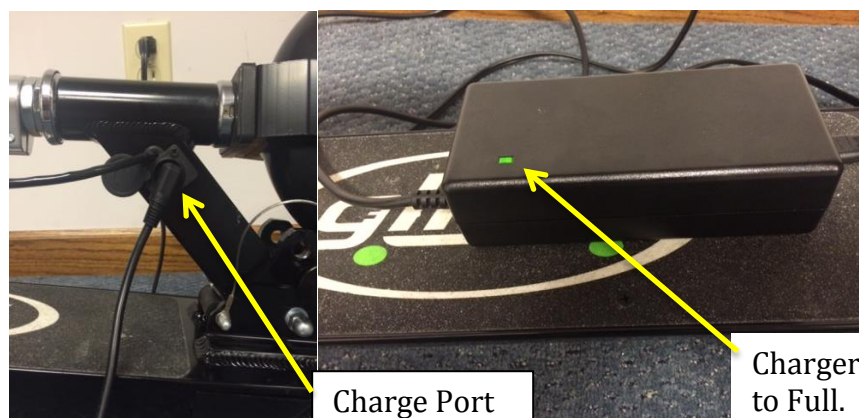

Charger Indicator Light. **Green**= Near Full to Full. **Blue** = Not Connected to Scooter
Red=Still Charging.

CHARGER:

1. When you plug the charger into wall and before you connect it to the scooter, the LED light on the charge shows blue. The battery is charging the scooter when the LED light on the charger is red. When the battery is 95% full, it will turn green. It will continue to charge with very small current for about 30 minutes after the LED turns green. When battery is 100% full, the charger will stop charging.
2. The provided charger has a built in overcharge protection to prevent the battery from being overcharged.
3. Charging time is approximately 3.5 hours for a fully discharged battery.
4. Regularly inspect the charger for damage to the cord, plug, enclosure and other parts. In the event of such damage, the charger must not be used until it has been repaired or replaced.

5. Unplug the charger from the wall outlet when not in use.
6. Use only the charger supplied with this scooter or a recommended replacement specified by Glion.



WARNING: Failure to confirm compatibility, properly install, operate and maintain any charger, component or accessory can result in serious injury or death.

INSTRUCTIONS FOR CHARGING:

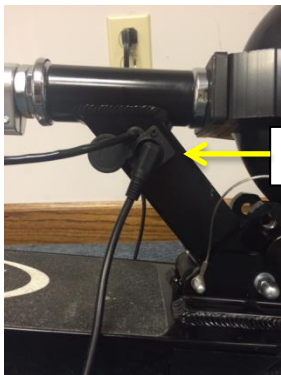

1. Turn the scooter off. The charge port **(K)** is located on the right side of the neck of the scooter above the folding mechanism. Open the charge port rubber protective cover and securely plug the charger into the charge port.
2. Plug the charger into the power outlet.
3. A solid red light on the charger indicates the battery is charging. A solid green light indicates the battery is fully charged.
4. Remove the plug from the power outlet, then remove the charger from the scooter's charging socket. Secure the charge port rubber protective cover.

USAGE:

1. You will not damage the battery by riding the scooter until the battery is fully discharged and the scooter motor shuts down. However, we do ask to promptly recharge the battery after full discharge. Do not store your scooter with an empty battery.
2. Avoid operating the scooter when the battery is hot.

BATTERY INDICATOR LIGHTS

1. The battery indicator screen **(J)** is located on the right handle grip. When the scooter is turned on, the battery indicator screen is lit.
2. F means the battery is fully charged. E indicates the battery is approaching empty.
3. The battery indicator screen is accurate when the motor is **not** engaged. When the scooter is standing still, check the battery indicator for battery capacity status. Do not check the battery indicator when operating the scooter.
4. **Soft Riding Condition.** When the battery is nearly depleted, a "soft" riding condition can occur. A "soft" riding condition means the scooter can move forward under partial throttle but under full throttle it shuts down. This occurs because under full throttle, a large instant current causes the voltage to drop in the battery reaching the controller stop limit to protect the battery and shut down the scooter. When this happens, turn the scooter back on and drive the scooter under partial throttle until you can recharge the battery.

DOLLY FEATURE



Center Button of the Dolly Handle

You must press the center button of the dolly handle to extend it from the board or retract it into the board. When you fully retract the dolly handle into board, make sure the handle locks into the operating position and is secure so that it cannot be retracted without first pressing the center button on the dolly handle.



The dolly handle has three positions. Position 1: The closed position. In this position, the dolly handle is fully retracted into the board and locked into place so that it cannot be extended without first pressing the center button. Position 2: The dolly handle is partially extended. This position is designed for ease in carrying the folded scooter in the vertical standing position (i.e.: up a set of stairs). Position 3: The dolly handle is fully extended. This position is for rolling the folded scooter behind or next to you. (The wheelies allow the scooter to roll by your side and also to stand vertically with the wheelies and the T-bar as the base.)



Dolly in the Vertical Standing Position

SCOOTER COVER (OPTIONAL ACCESSORY)

1. Cover Installation and Removal

Fold your Glion Electric Scooter and place it horizontally on the floor and drape the cover over the front tire and across the scooter.



Pull the bottom of the cover over the T-bar so the cover now extends from the front tire on one side to the bottom of the T-bar on the other side.



Tilt your scooter upright and zip the cover down to the rear tire.



To Remove the Scooter Cover Reverse the Installation Steps.

2. Handlebar Carrying Access



The scooter cover has two slits in the side so you can easily carry the scooter holding the lower handlebar downtube.

3. Cover Storage Pouch



The scooter cover also serves as a storage pouch for the cover. The cover can be stuffed into a sewn pouch located inside of the cover. First, access the pouch from the opening in the cover for the retractable handle and carefully reverse the pouch so you can see the pouch's glion logo. Stuff the scooter cover inside of the pouch. The pouch's Glion logo should continue to face outside. Once the cover is completely stuffed inside of the pouch, pull the cover straps and snap for a carrying handle.



WARNING: Check to make sure the dolly handle is fully retracted into the board and locked into place before operating the scooter. Failure to do so could result in serious injury or death.

GLION ELECTRIC SCOOTER MAINTENANCE

MECHANICAL:

1. Due to vibration, nuts and bolts can become loose. Make sure that all lug nuts, other nuts and bolts are securely fastened and tighten them if necessary. To test: Pick your scooter up 1-2 inches and bounce it off the ground. Do a quick visual and tactile inspection of the whole scooter. Make sure you inspect all visible nuts, bolts, and structural welds. If anything sounds, feels, or looks loose, or shows signs of stress replace or secure them.



WARNING: Like any mechanical device, an electric scooter and its components are subject to wear and stress. Different materials and mechanisms wear or fatigue from stress at difference rates and have different life cycles. If a component's life cycle is exceeded, the component can suddenly and catastrophically fail, causing serious injury or death to the rider. Scratches, cracks, fraying and discoloration are signs of stress-caused fatigue and indicate that a part is at the end of its useful life and needs to be replaced. While the materials and workmanship of your electric scooter or of individual components may be covered by a warranty for specified period of time by

the manufacturer, this is no guarantee that the product will last the term of the warranty. **Product life is often related to the kind of riding you do and to the treatment to which you submit your electric scooter.**

BATTERY:

When used normally, the lithium battery provided with your scooter should not lose more than 30% of its capacity within the first 500 charging cycles. Average battery life for a properly maintained lithium ion battery is approximately 1,000 charge/discharge cycles. If you notice your travel distance significantly diminished despite having a full charge, it is a sign the lithium ion battery needs to be replaced.

Fully charge the battery before storing the scooter for extended periods. Periodically recharge the battery at least every 3 months during storage. Leaving the battery depleted and uncharged for more than 3 months could permanently damage the battery and is not covered by warranty.

BATTERY DISPOSAL:

Your Glion product uses lithium ion batteries, which must be recycled or disposed of in an environmentally safe manner. Do not dispose of a lithium ion battery in a fire. The battery may explode. Do not dispose of a lithium ion battery with your household trash. The incineration, landfilling, or combining a lithium ion battery with your household trash is prohibited in most jurisdictions. Locate a place that collects and recycles lithium ion batteries. To search online, go to www.call2recycle.org and enter your zip code, or if you prefer to locate a place by phone, dial 1-877-2-RECYCLE to find the nearest retailer that collects lithium ion batteries.

STORAGE AND DAILY CARE

1. Do not store the scooter in direct sunlight, in damp places, or in temperatures below -5° C (23° F) or above 43° C (110° F).
2. Fully charge the battery every three months if not in use.
3. Keep the scooter clean (See section on Cleaning and Servicing).

GENERAL TROUBLESHOOTING

If you experience problems with your scooter, please refer first the following troubleshooting guide:

Problem: The scooter does not operate.

Possible causes/solutions:

1. The scooter is not turned on. **Solution:** Turn on scooter by pressing and holding the on/off button approximately 2 seconds.
2. The battery is not charged. **Solution:** Charge Battery.
3. The left twist grip electronic brake is inadvertently engaged. **Solution:** Make sure electronic brake is not accidentally twisted.
4. The operator is not engaging the motor by manually kicking the scooter. **Solution:** The scooter must be slowly rolling forward at a minimum speed to engage the motor.

Problem: The Scooter Operates Intermittently.

Possible causes/solutions:

1. The battery is low on charge causing soft riding condition. See Page 17 of User Manual for description of soft riding condition. **Solution:** Recharge Battery.

Problem: Short ride time/runs slow.

Possible causes/solutions:

1. Rider weight. **Solution:** Do not exceed 115 kg (255 lbs.) maximum weight limit.

2. Riding conditions. **Solution:** Use only on flat, dry surfaces. Avoid steep inclines and areas with debris on surface.
3. Battery not fully charged. **Solution:** Charge battery until full.
4. Old/Damaged Battery. **Solution:** Replace Battery. Contact Customer Service on our website: www.glion-scooter.com.

IF YOU'VE CONSULTED THE TROUBLESHOOTING GUIDE AND ARE STILL HAVING PROBLEMS WITH YOUR SCOOTER, PLEASE CONTACT CUSTOMER SERVICE ON OUR WEBSITE: www.glion-scooter.com. Also visit our website for replacement parts, product support, and instructional videos. Use only replacement parts supplied by Glion.

CLEANING, STORING, AND SERVICING

1. **KEEP YOUR SCOOTER DRY:** Do not ride your scooter in wet conditions unless unavoidable. Dry off your scooter immediately.
2. **KEEP YOUR SCOOTER CLEAN:** Remove dust and dirt from your scooter with a wrung-out, damp rag. Dry immediately. Never use solvents. Do not spray your scooter down with water or submerge it.
3. **STORAGE:** Battery performance is susceptible to temperature. Do not store your scooter in direct sunlight or in a high temperature environment like inside of your car. Store your scooter indoors, out of the elements. Room temperature is ideal for storage. Avoid storing the scooter in wet environments. Recharge the battery in full after it has been completely discharged and before storing the scooter for longer periods. Even in storage, please monitor the battery level and recharge the battery fully at least once every 3 months.
4. **SERVICE.** Should your scooter require service, please contact customer service through our website www.glion-scooter.com. Your satisfaction is our greatest priority! Glion!

PRODUCT REGISTRATION

We encourage you to register your Glion Electric Scooter with us. Registration helps us ensure your continued satisfaction and enables us to contact you with new product instructions. Also, registration and proof of purchase are necessary to make a warranty claim. Please register your Glion Electric Scooter at www.glion-scooter.com/register. Please keep your original proof of purchase in a safe place in the event of a warranty claim.



WARNING: Please register your electric scooter with us. If you don't, we may not be able to contact you directly with important safety recall information.

GLION LIMITED WARRANTY

Your Glion Electric Scooter is covered by a warranty. For the specifics of this warranty, visit our website at www.glion-scooter.com.

UNDER NO CIRCUMSTANCES SHALL PROBITY CELL LLC, DBA GLION® (“Probity Cell”) BE LIABLE FOR CONSEQUENTIAL, INCIDENTAL OR SPECIAL DAMAGES ARISING DIRECTLY OR INDIRECTLY IN CONNECTION WITH USE, OR INABILITY TO USE, THIS PRODUCT. IN NO EVENT SHALL PROBITY CELL’S LIABILITY FOR BREACH OF WARRANTY, BREACH OF CONTRACT, NEGLIGENCE OR STRICT LIABILITY EXCEED THE COST OF THE PRODUCT COVERED HEREBY. NO PERSON IS AUTHORIZED TO ASSUME FOR PROBITY CELL ANY OTHER LIABILITY IN CONNECTION WITH THE SALE OF THIS PRODUCT.

Some states do not allow the exclusion or limitation of consequential, incidental or special damages, so the above limitation or exclusion may not apply to you. Probity Cell’s limited warranty gives you specific legal rights, and you may also have other rights, which vary from state to state.

YOUR INSURANCE POLICIES MAY NOT PROVIDE COVERAGE FOR ACCIDENTS INVOLVING THE USE OF THIS SCOOTER. TO DETERMINE IF COVERAGE IS PROVIDED, YOU SHOULD CONTACT YOUR INSURANCE COMPANY OR AGENT.